

---

Fitting instructions

---

Make: Jeep

---

Cherokee; 2001->

---

Type: 4588

---

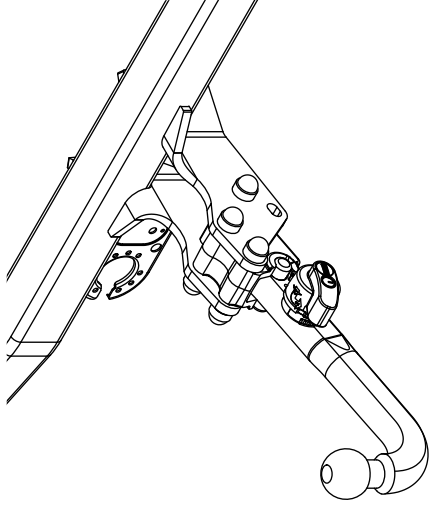

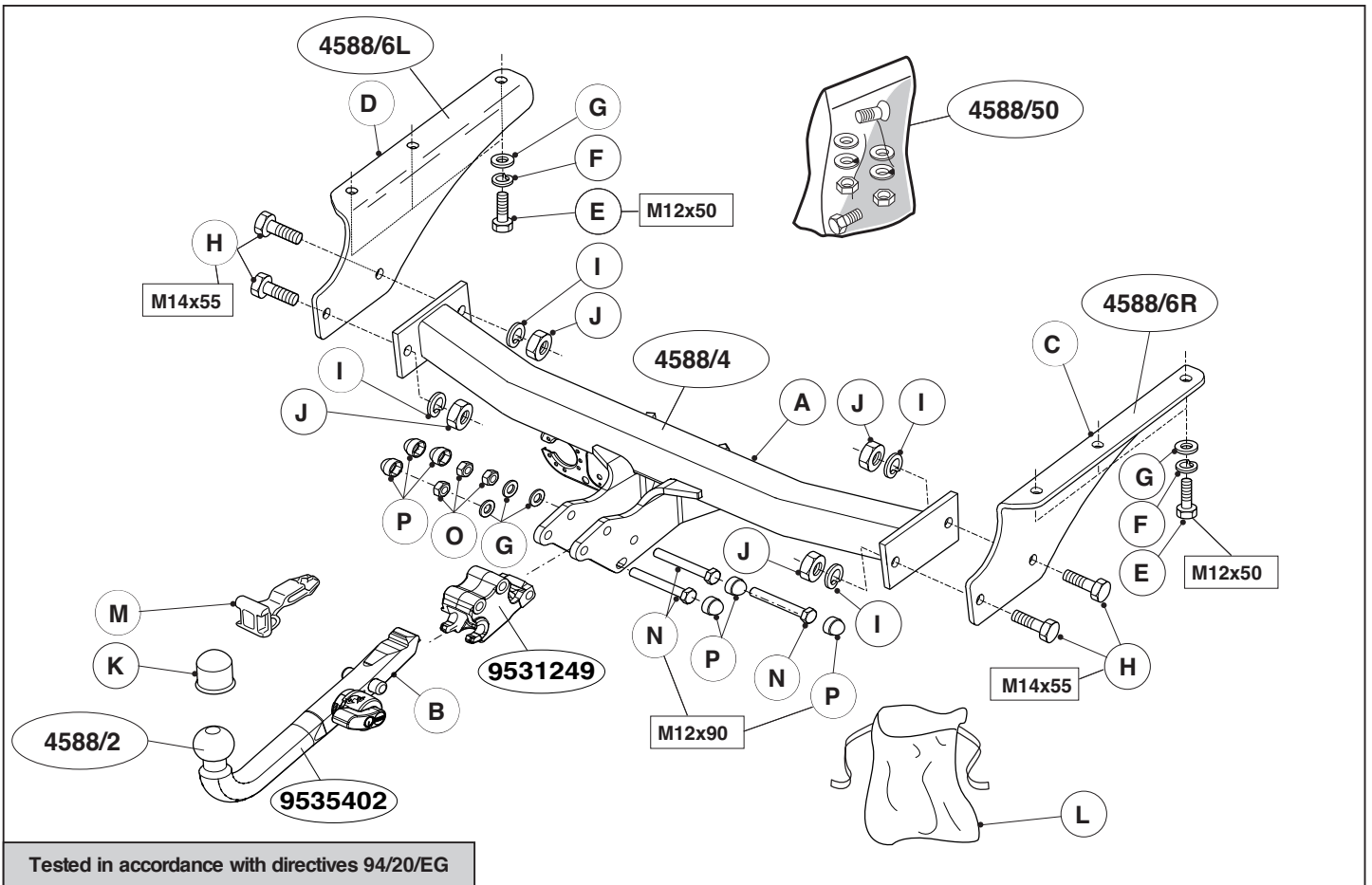

Tested in accordance with directives 94/20/EG

© 458870/10-04-2009/1

© 458870/10-04-2009/18



**Istruzioni da conservare**

Dispositivo di traino tipo: Brink 4588  
 Per autoveicoli: Jeep KJ  
 Tipo funzionale: Classe e tipo di attacco: A50-X  
 Approvazione N.: e11 00-5836  
 Valore D: 15,1kN  
 Carico max. verticale S: 140 kg  
 Larghezza rimorchiabile: Per il triano di caravans o TATS e consentita una larghezza di 2,81 m  
 Massa rimorchiabile: vedi carta di circolazione dell' autoveicolo

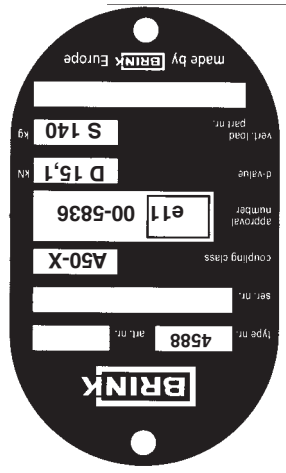

© 458870/10-04-2009/17

**DICHIARAZIONE DI CORRETTO MONTAGGIO**  
 Si dichiara che il dispositivo di attacco tipo.....  
 In fede è stato installato sull' auto veicolo.....  
 .....targa.....  
 in conformità alle prescrizioni sia del costruttore del veicolo che del costruttore del dispositivo stesso.

(6x) M12x50 (10.9)

(3x) M12x90

(4x) M14x55

(6x) M12

(4x) M14

(9x) M12

(3x) self-locking M12

(4x) M14

(6x) M12

© 458870/10-04-2009/2

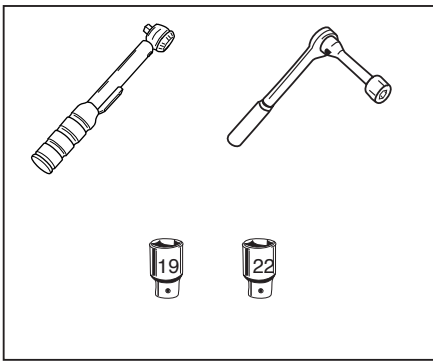

**D-value**

$$D = \frac{\begin{matrix} 2750 \text{ K.G max} \\ 3500 \text{ K.G max} \end{matrix} \times \begin{matrix} 2750 \\ 3500 \end{matrix}}{\begin{matrix} 2750 \text{ K.G max} \\ 3500 \text{ K.G max} \end{matrix} + \begin{matrix} 2750 \\ 3500 \end{matrix}} \times \frac{9.81}{1000} = 15,1 \text{ kN}$$

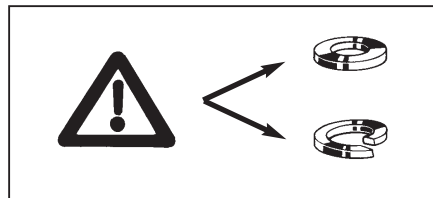
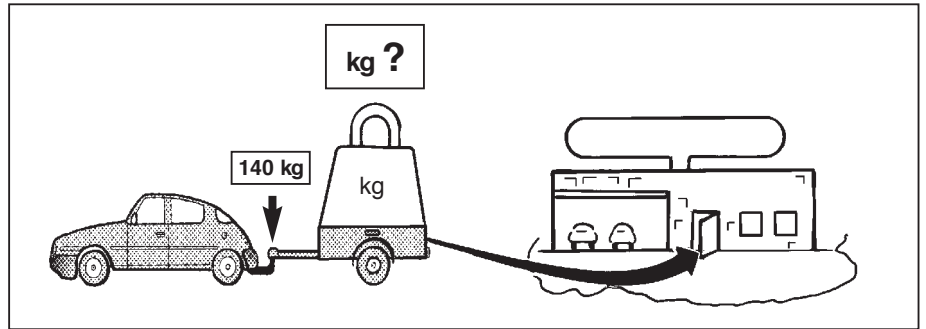
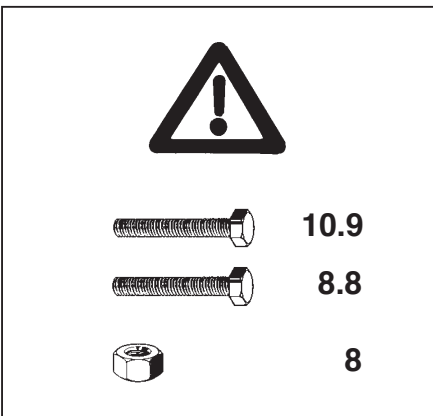

© 458870/10-04-2009/3

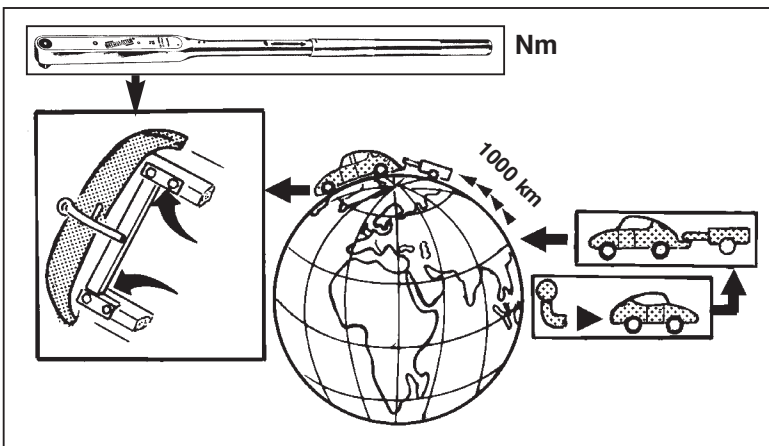

**HINWEISE:**

- \* Die für das Fahrzeug zugelassene Anhängelast ist den Fahrzeug Unterlagen zu entnehmen. Bei Änderungen des Fahrzeuggewichtes muß die höchstzulässige Anhängelast gegebenenfalls aus dem D-Wert nachgerechnet werden. Auskunft hierüber kann Ihr Fachhändler oder der TÜV geben.
- \* Elektrische Anlage gemäß StVZO anbringen.

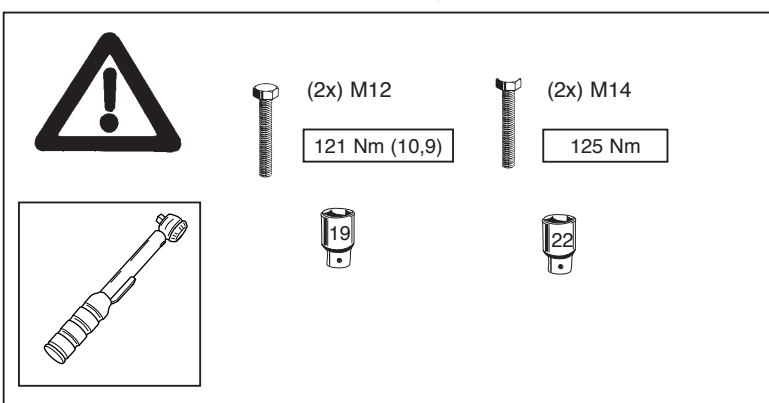

© 458870/10-04-2009/16

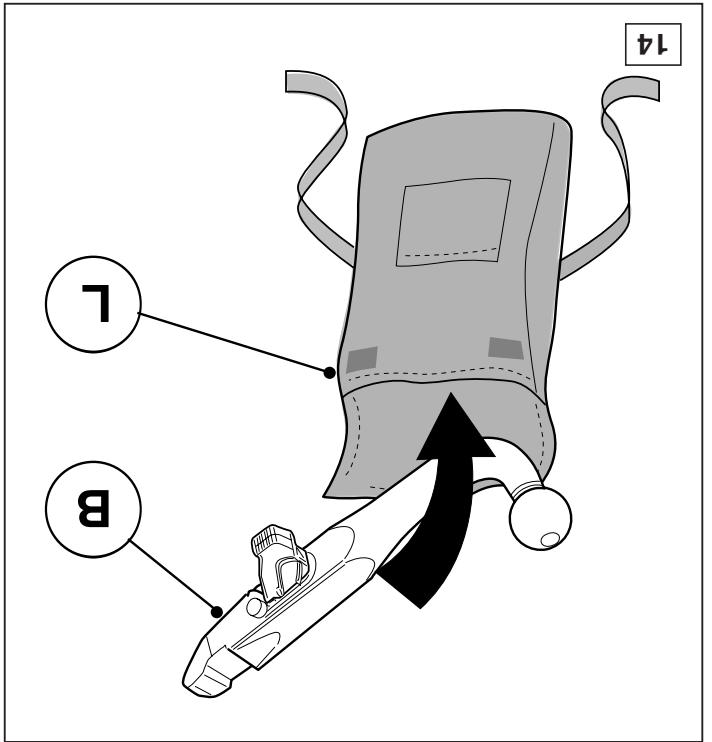
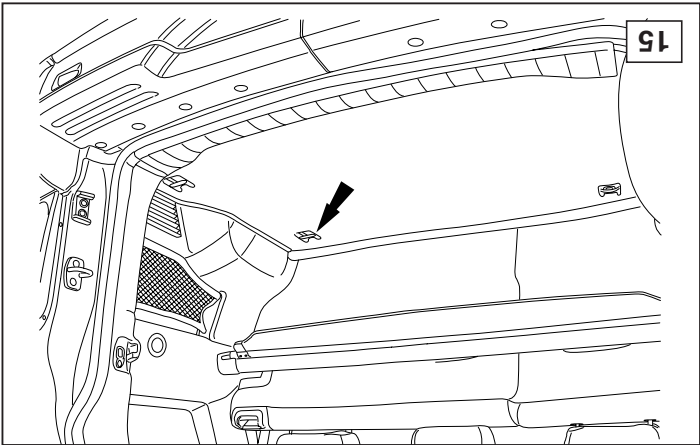
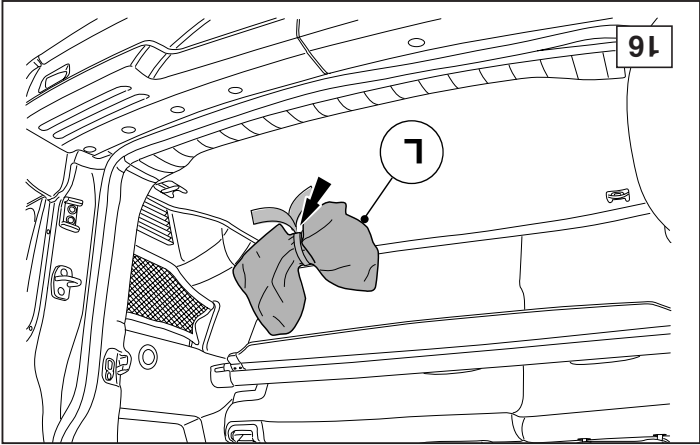
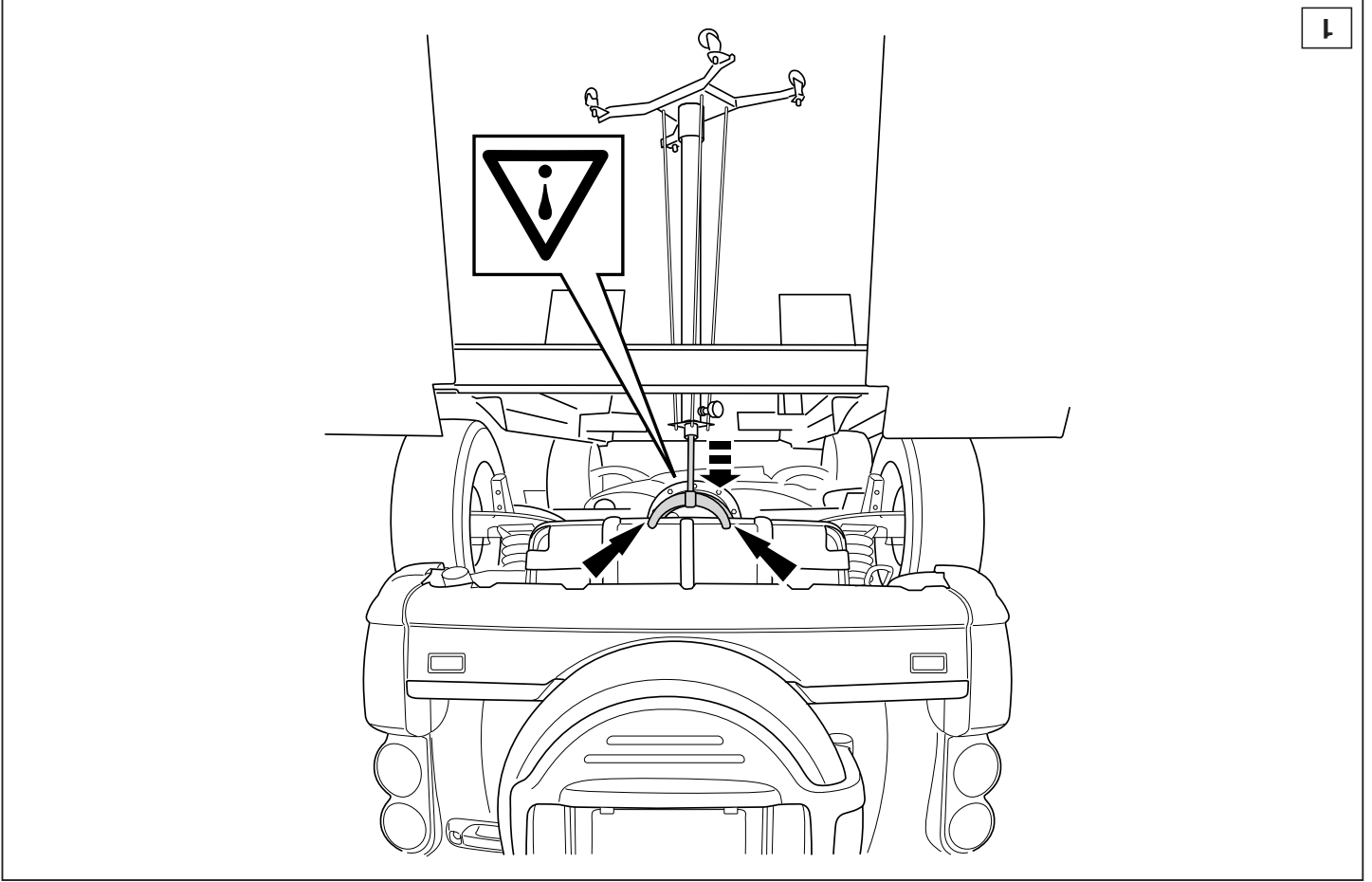

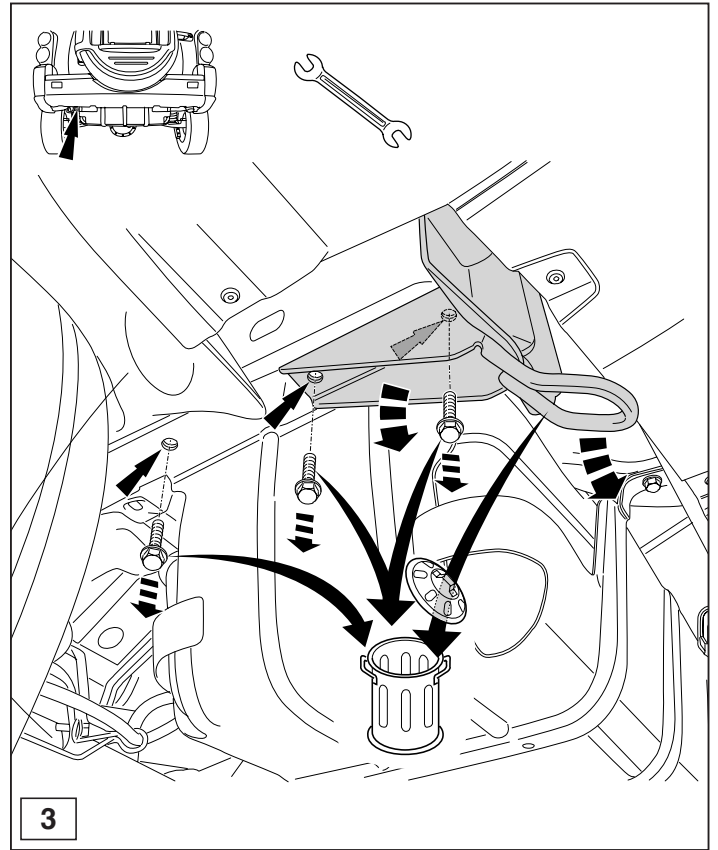
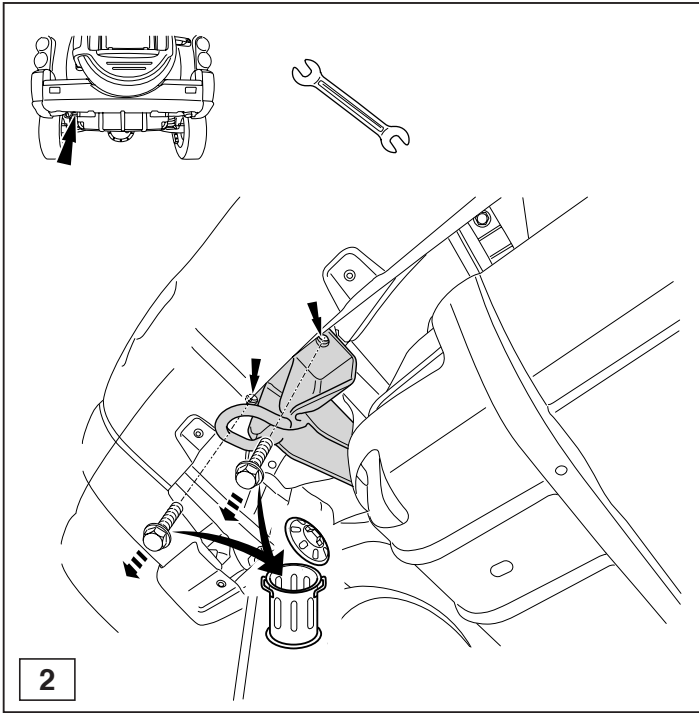

© 458870/10-04-2009/5

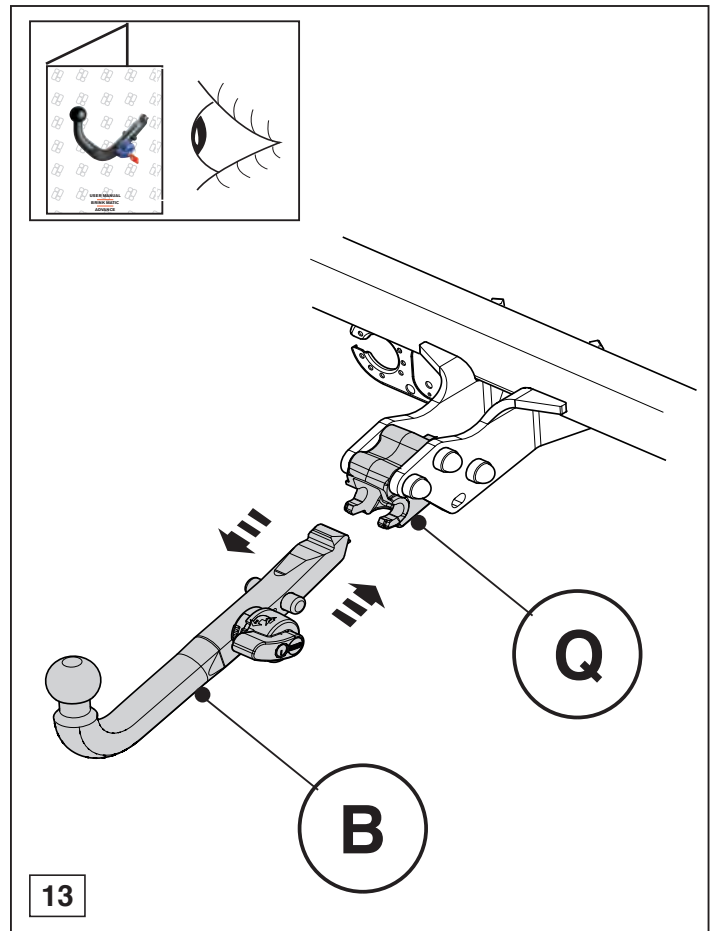
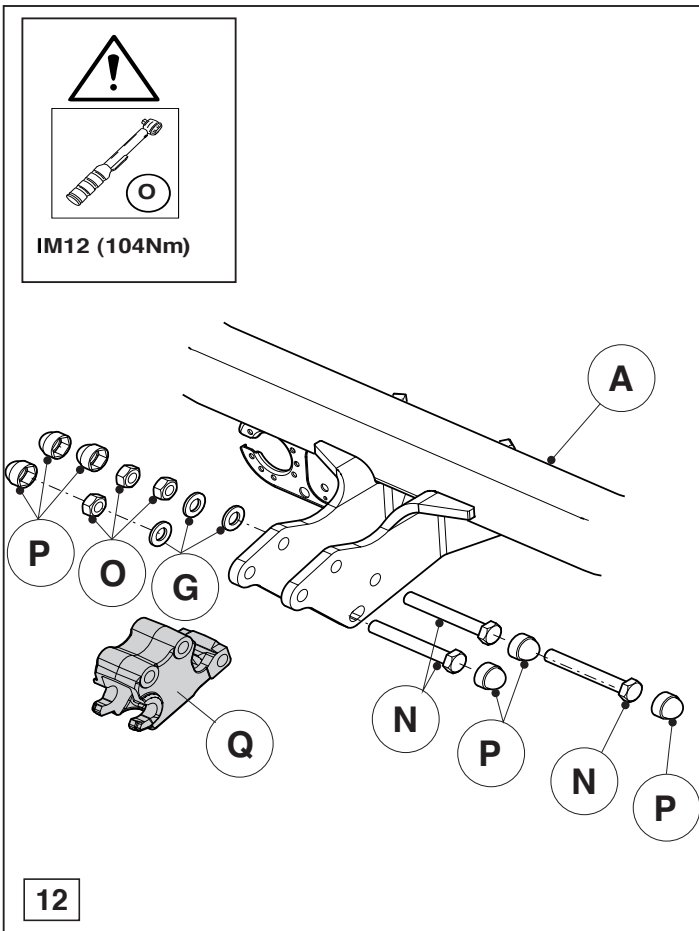

© 458870/10-04-2009/14

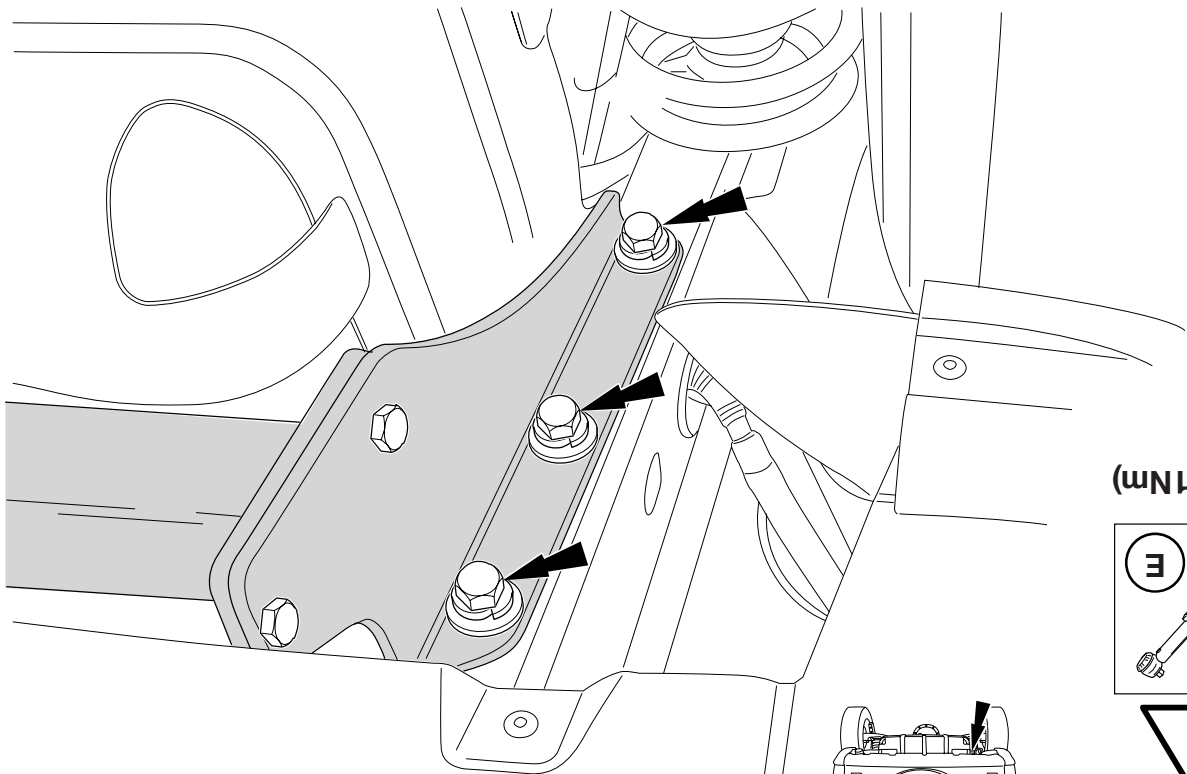
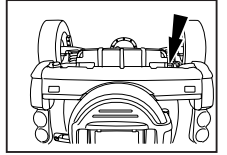
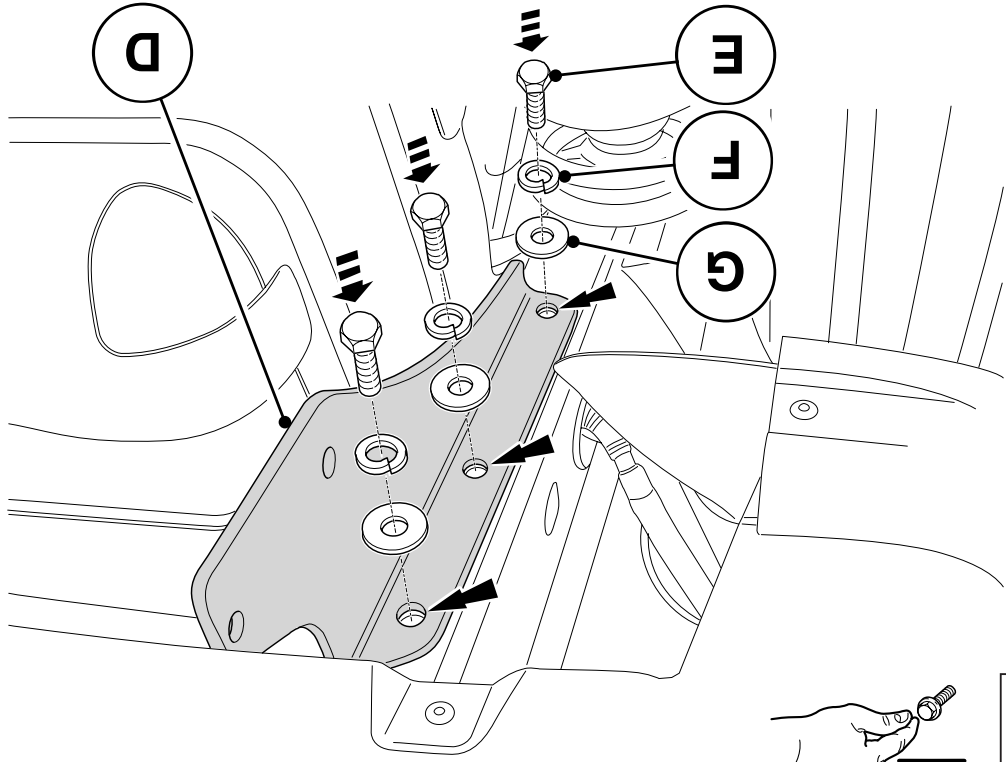

M12 (121Nm)

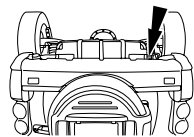
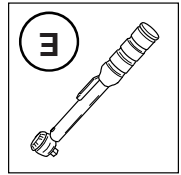

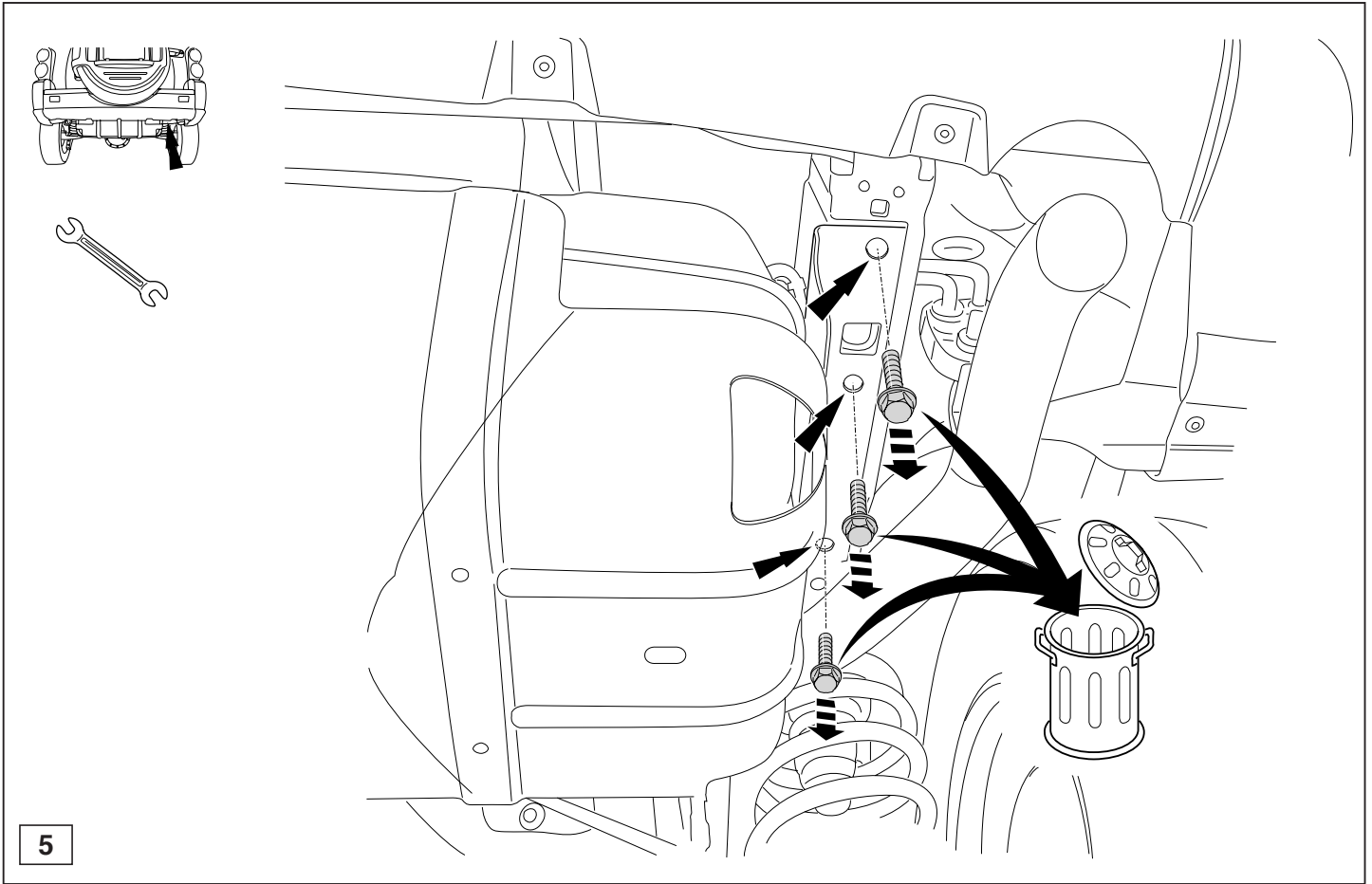

© 458870/10-04-2009/7

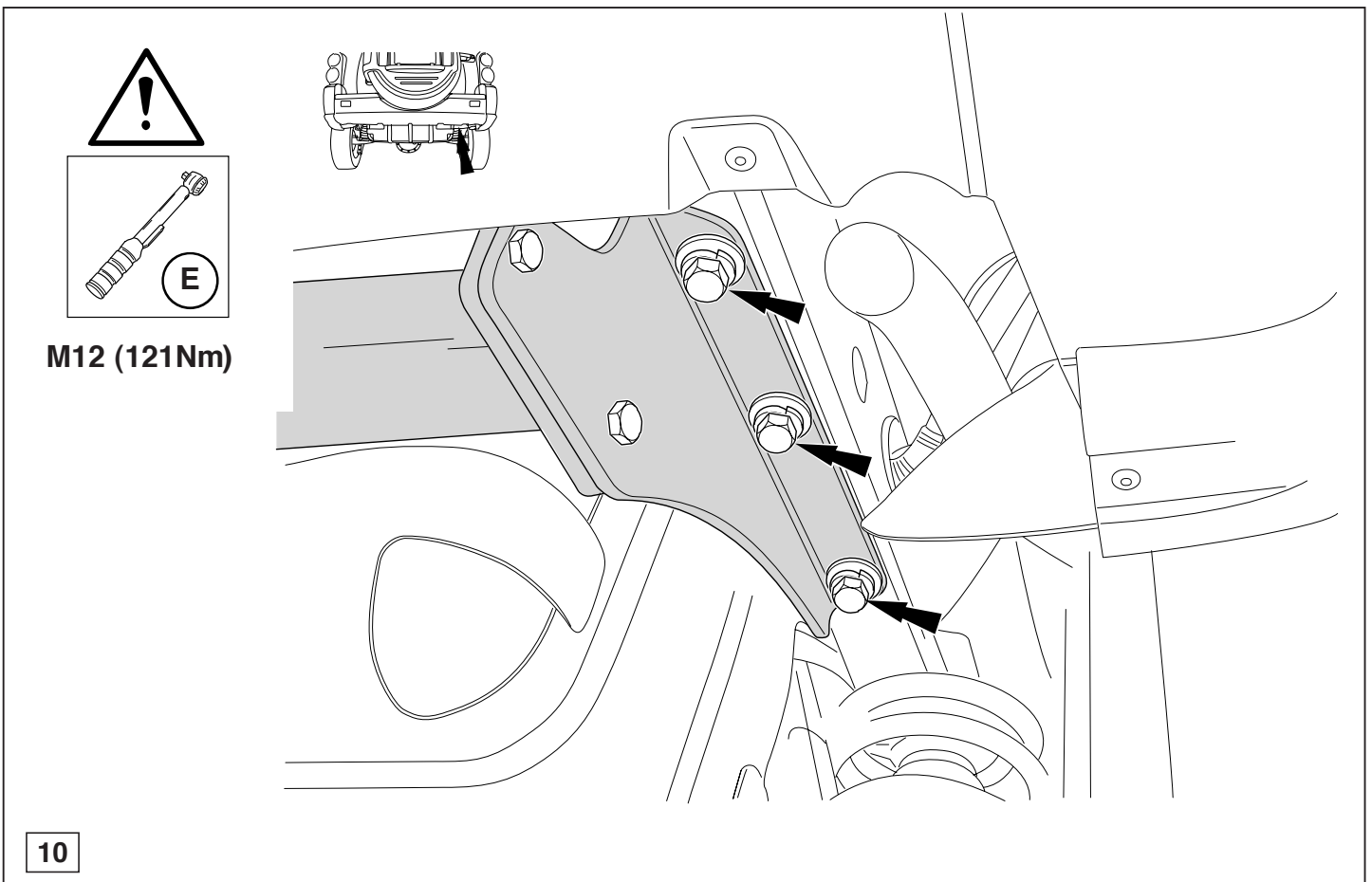

© 458870/10-04-2009/12



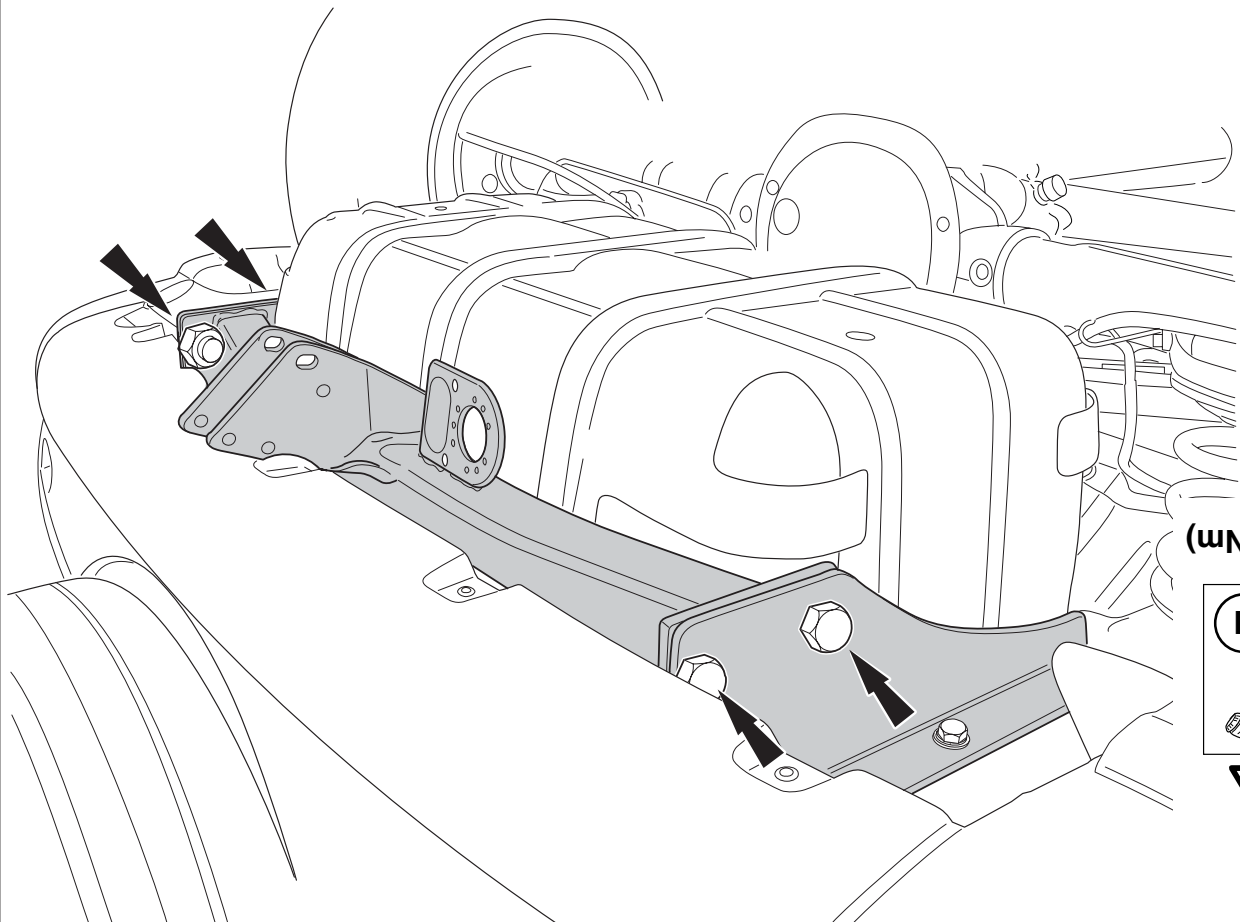
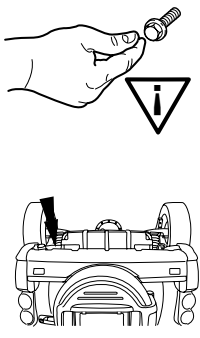
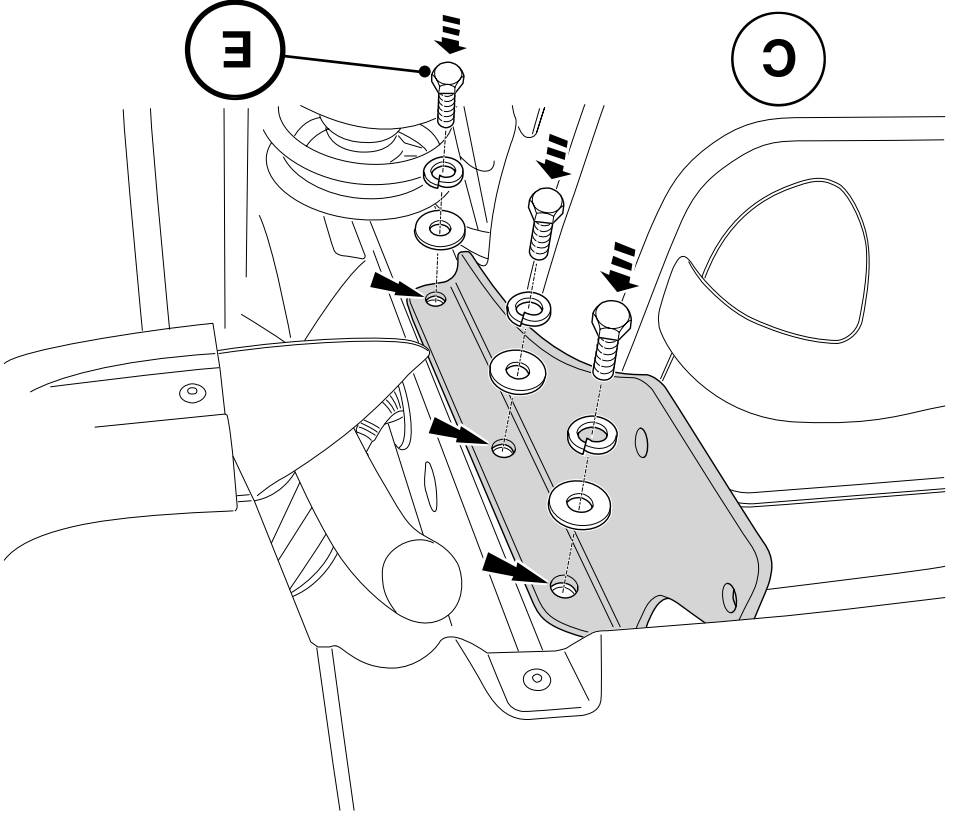

M14 (125Nm)

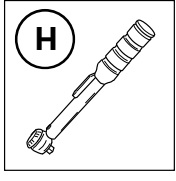

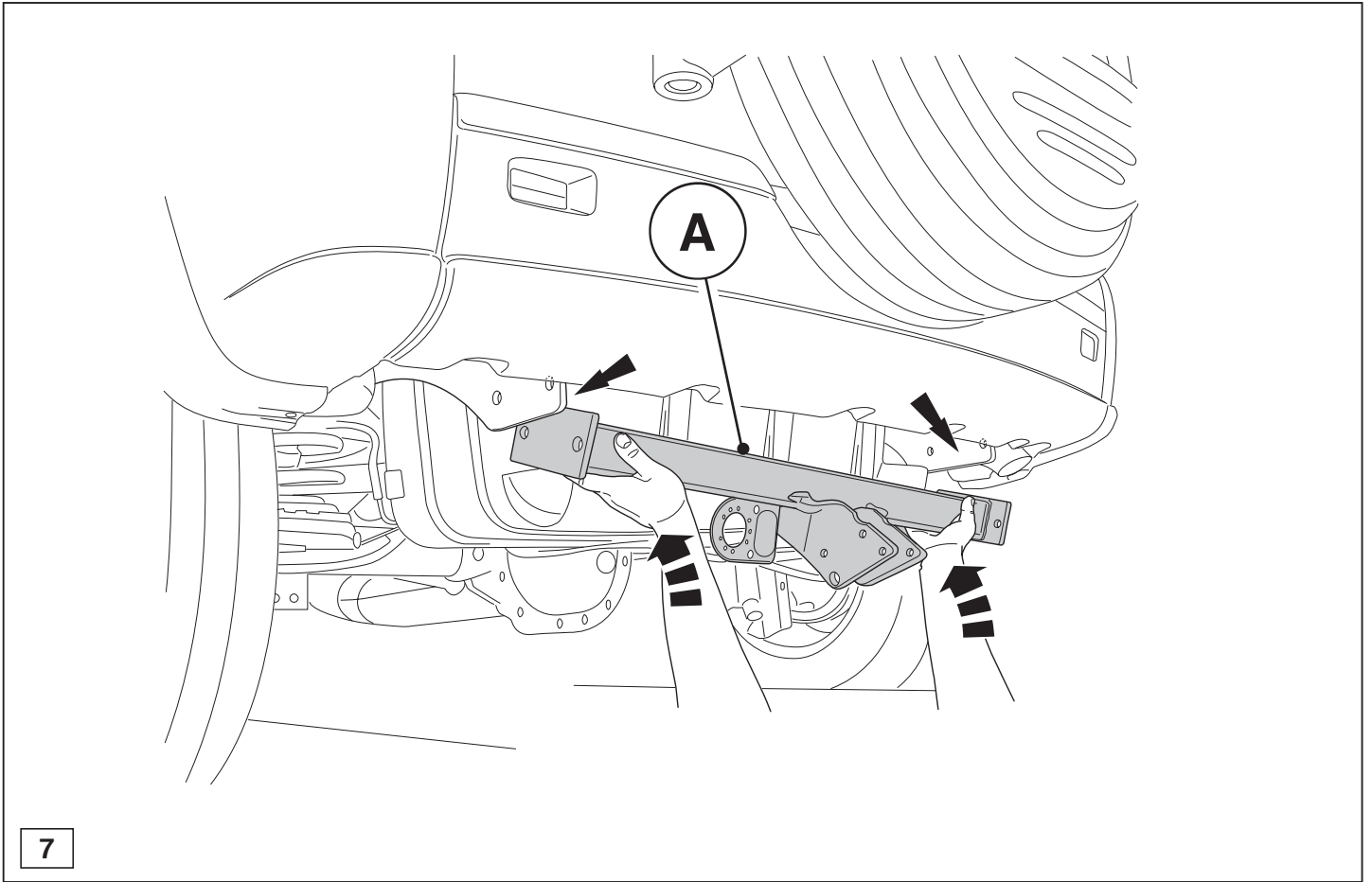

© 458870/10-04-2009/9

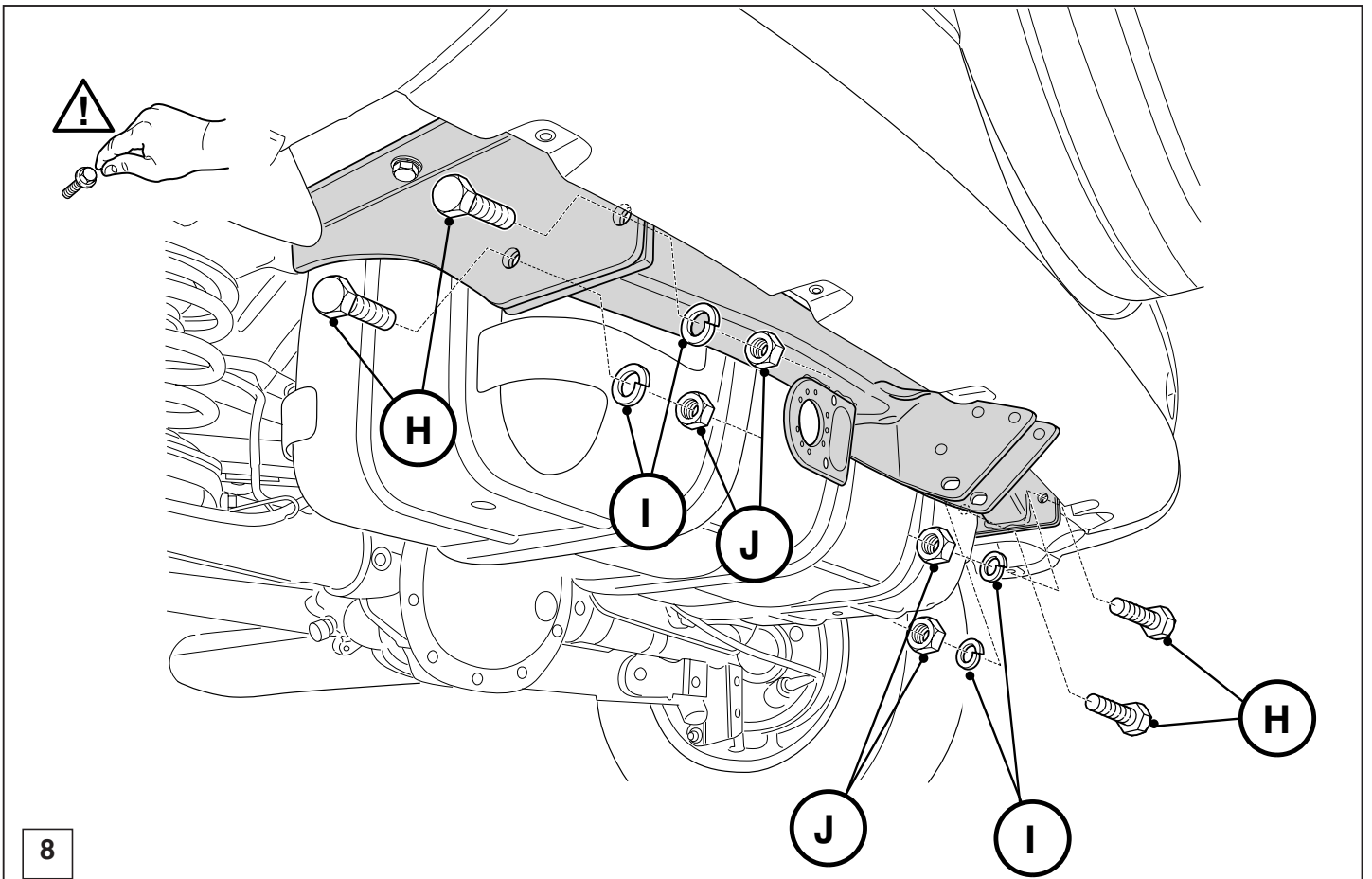

© 458870/10-04-2009/10