

**Einbauanleitung Elektrosatz  
Anhängervorrichtung mit 12-N Steckdose  
lt. DIN/ISO Norm 1724**

**Instructions de montage du faisceau  
électrique pour crochet d'attelage  
conforme à la norme  
DIN/ISO 1724 prise 12-N**

**Fitting instructions electric wiringkit  
towbar with 12-N socket up to  
DIN/ISO norm 1724**

**Montage-handleiding elektrokabelset voor  
trekhaak met 12-N contactdoos  
vlg. DIN/ISO norm 1724**

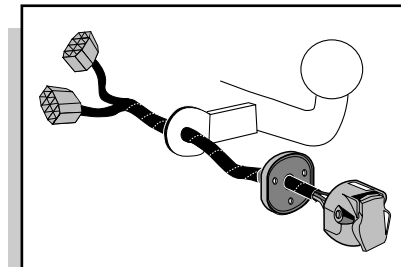

**FIAT BRAVO/BRAVA 1995-**

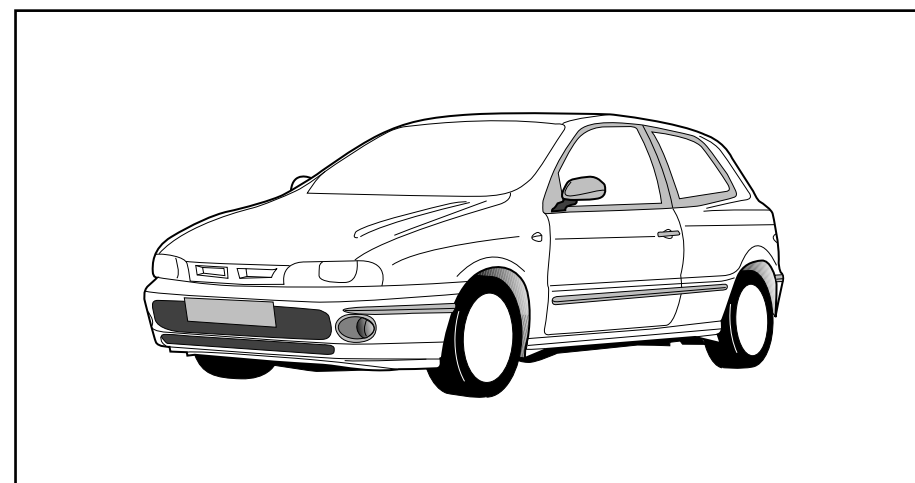

**Bestel Nr.: FIA-040-B**



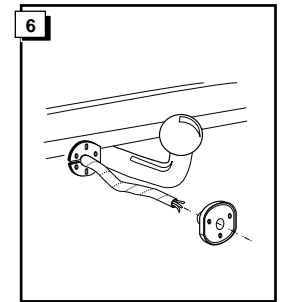
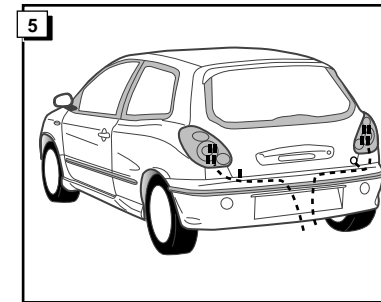
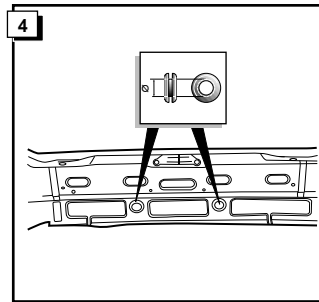
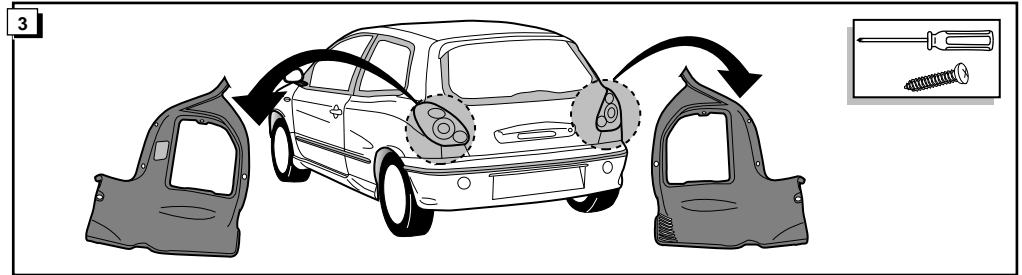
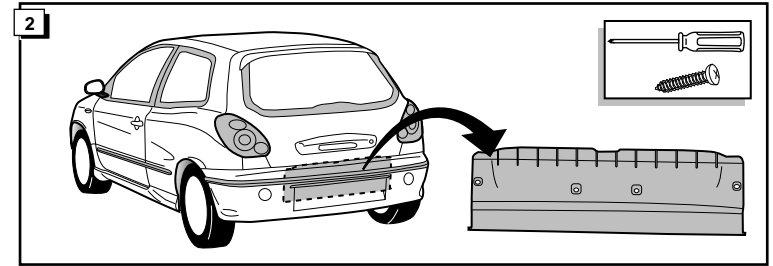
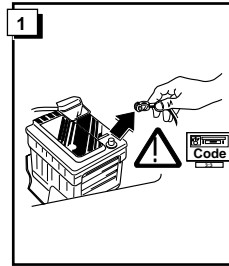

**7**

BLINKER LINKS  
CLIGNOTANT GAUCHE  
L.H. INDICATOR  
KNIPPERLICHT LINKS

BLINKER RECHTS  
CLIGNOTANT DROIT  
R.H. INDICATOR  
KNIPPERLICHT RECHTS

BREMSLEUCHE  
FEUX DE STOP  
BRAKELIGHTS  
REMLICHTEN

SCHLUßLEUCHE LINKS  
FEU ARRIERE GAUCHE  
L.H. REARLIGHT  
ACHTERLICHT LINKS

SCHLUßLEUCHE RECHTS  
FEU ARRIERE DROIT  
R.H. REARLIGHT  
ACHTERLICHT RECHTS

MASSE  
MASSE  
EARTH  
MASSA

	D	FR	GB	NL
1 = L	GELB	JAUNE	YELLOW	GEEL
2 = 54-G	BLAU	BLEU	BLUE	BLAUW
3 = 31	WEIß	BLANC	WHITE	WIT
4 = R	GRÜN	VERT	GREEN	GROEN
5 = 58-R	BRAUN	MARRON	BROWN	BRUIN
6 = 54	ROT	ROUGE	RED	ROOD
7 = 58-L	SCHWARZ	NOIR	BLACK	ZWART
8 = 58-B	GRAU	GRIS	GREY	GRIJS

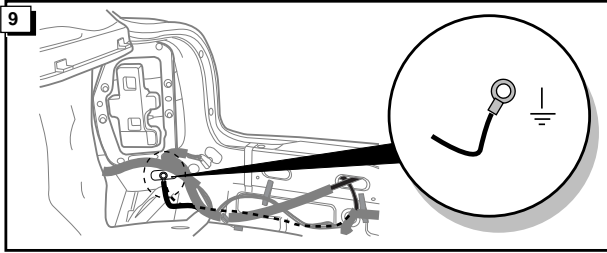
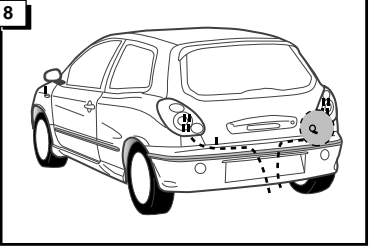

**INFO**

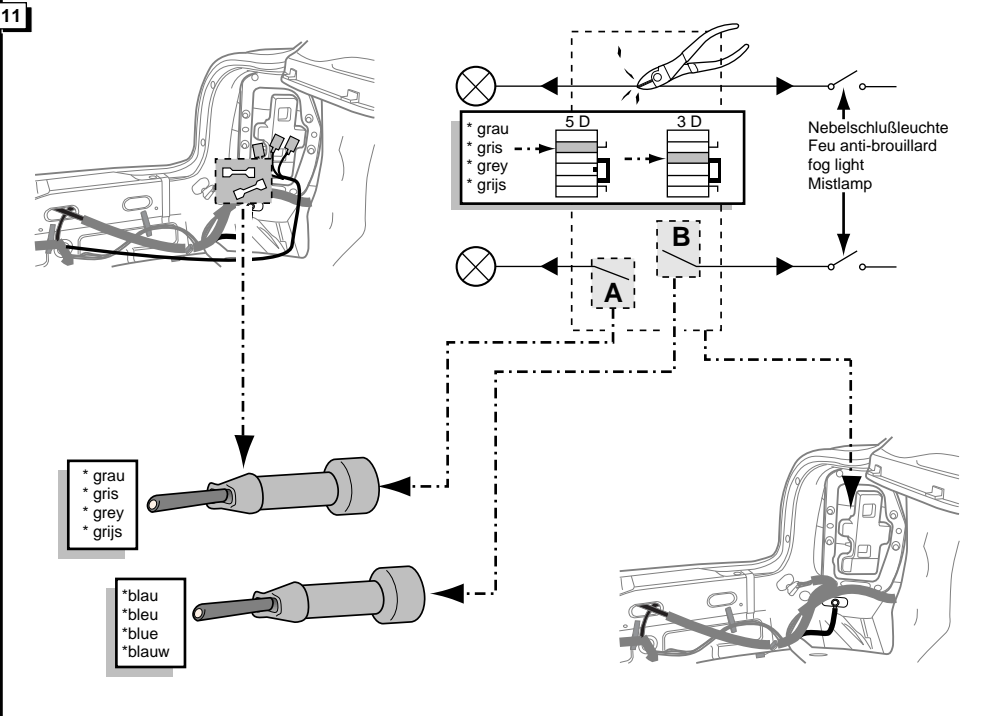
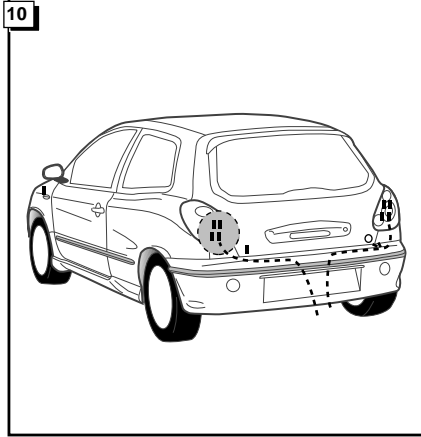
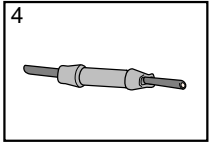
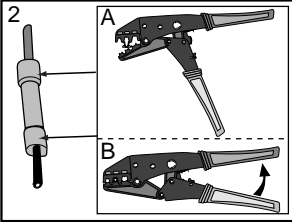
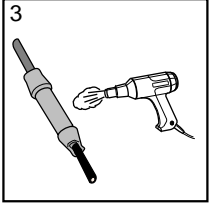
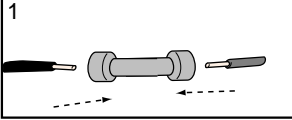

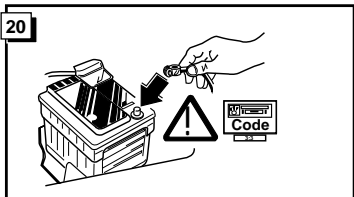
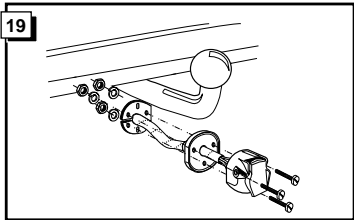

21

**! FUNKTIONEN KONTROLIEREN !**  
**CONTRÔLER LES FONCTIONS !**  
**CHECK FUNCTIONS !**  
**CONTROLEER FUNCTIES !**

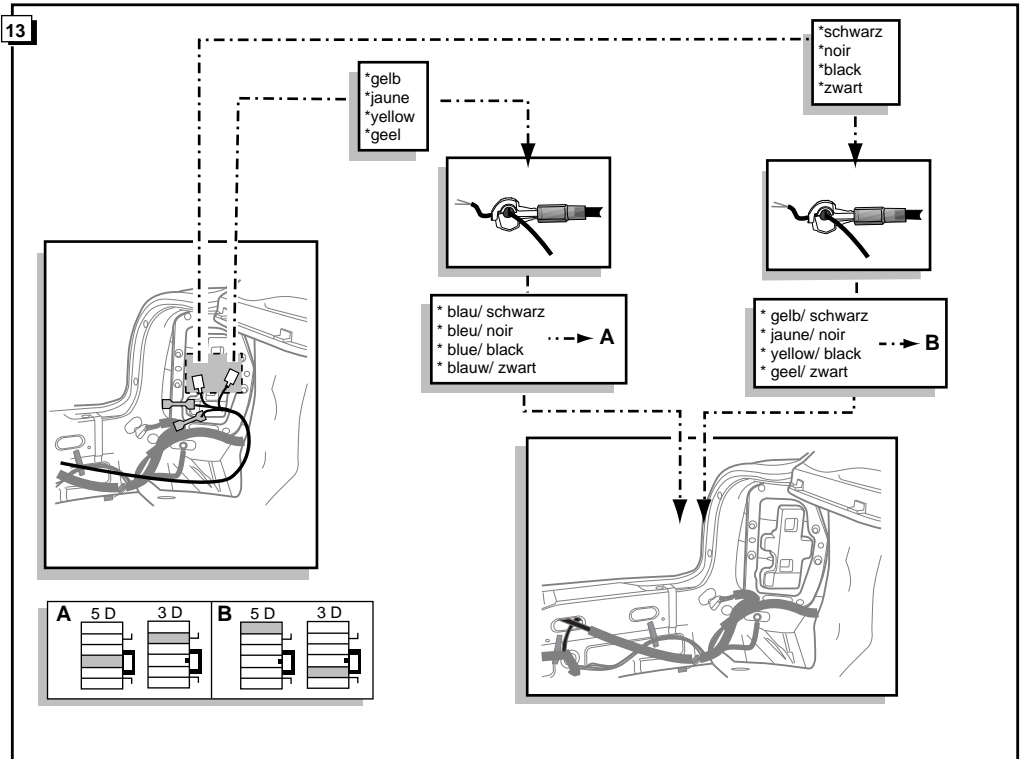
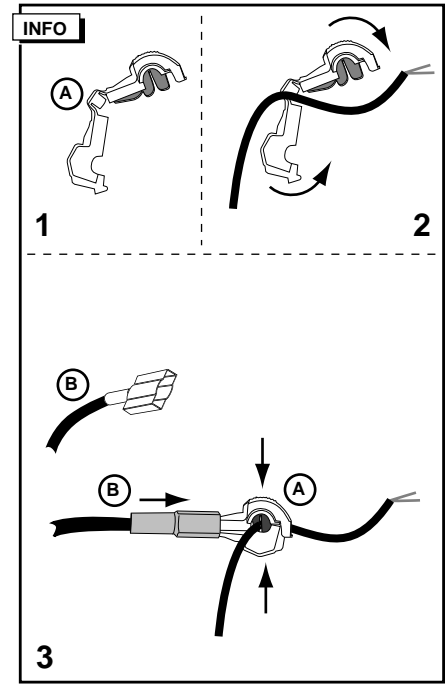
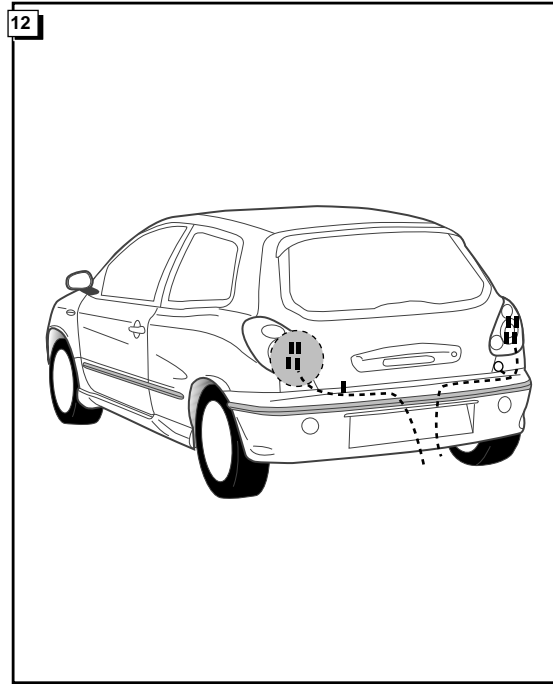
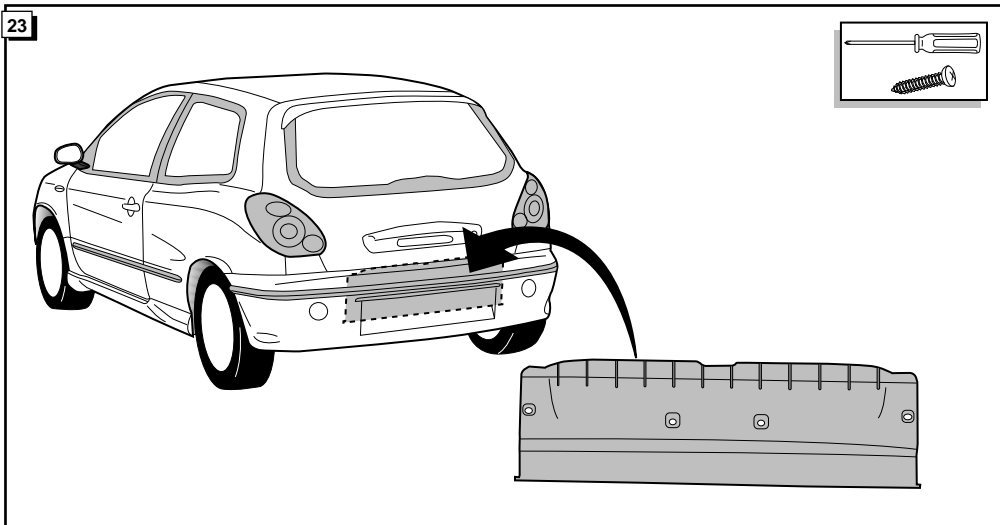
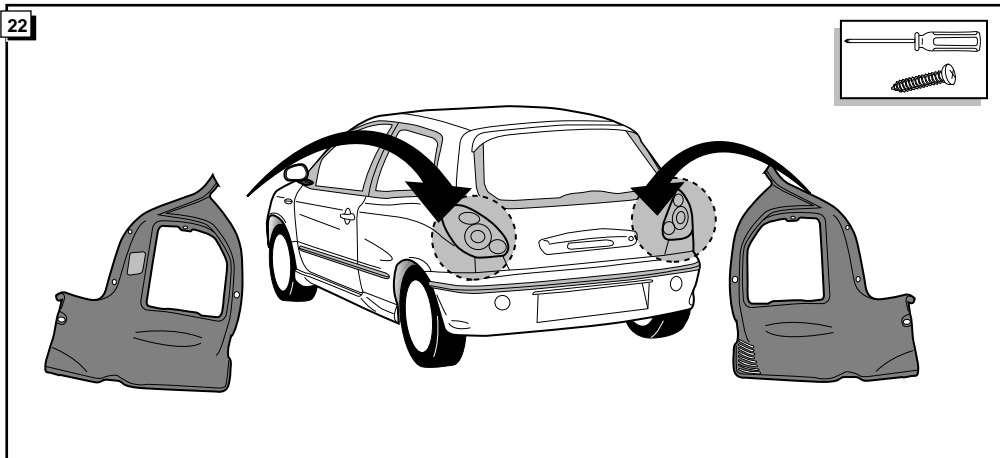

14

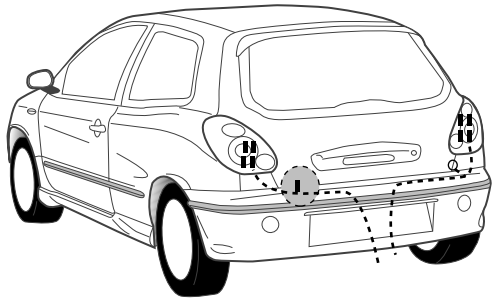

15

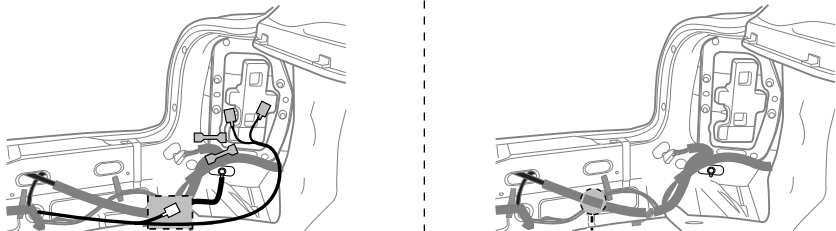

\*rot  
\*rouge  
\*red  
\*rood

\*rot  
\*rouge  
\*red  
\*rood

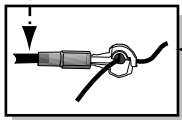
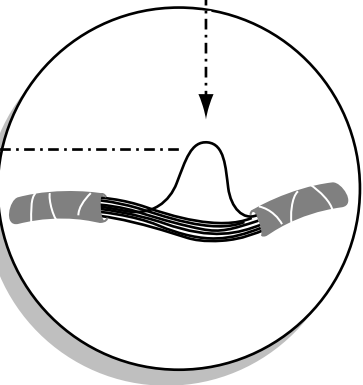

16

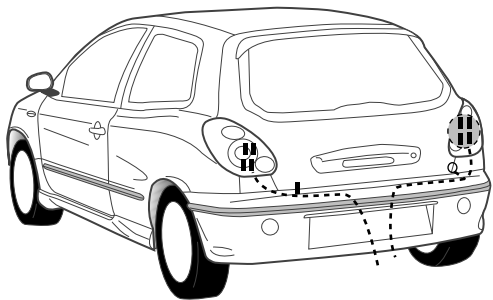

17

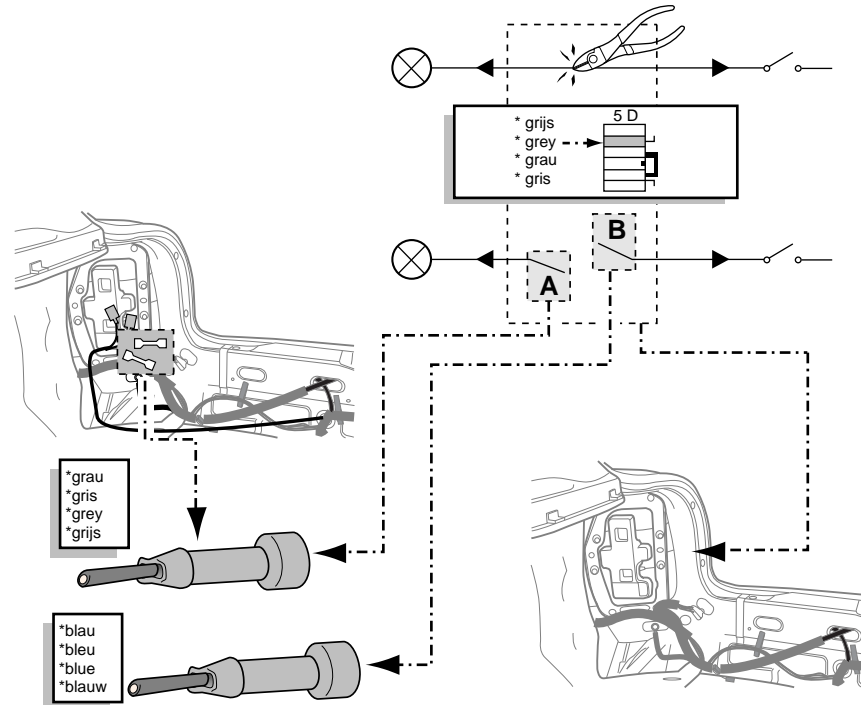

18

