

**Einbauanleitung Elektrosatz  
Anhängervorrichtung mit 13-P Steckdose  
lt. DIN/ISO Norm 11446**

**Instructions de montage du faisceau  
électrique pour crochet d'attelage  
conforme à la norme  
DIN/ISO 11446 prise 13-P**

**Fitting instructions electric wiringkit  
towbar with 13-P socket up to  
DIN/ISO norm 11446**

**Montage-handleiding elektrokabelset voor  
trekhaak met 13-P contactdoos  
vlg. DIN/ISO norm 11446**

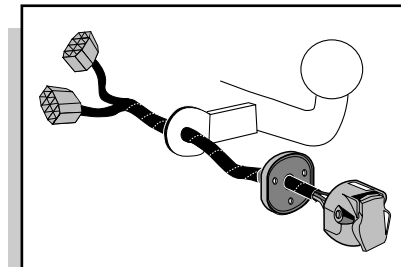

NISSAN PRIMERA SEDAN 2001-

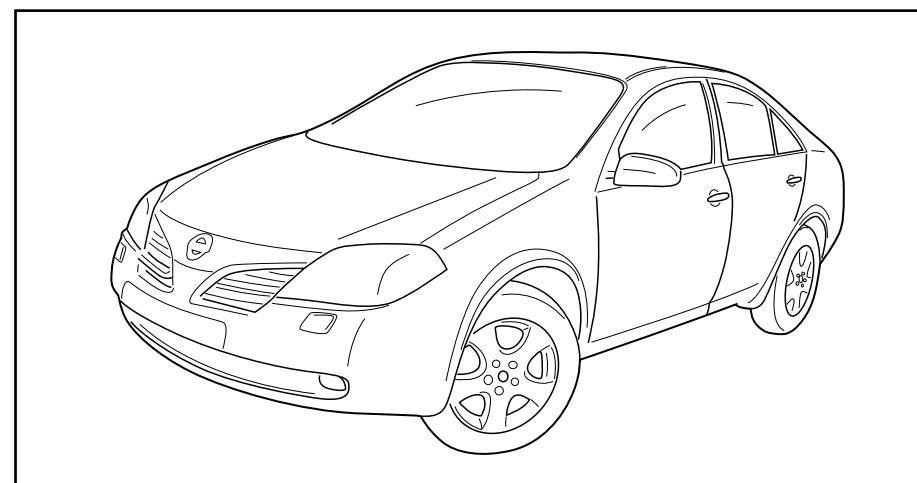

Bestel Nr.: NI-020-DL

\* Teilliste

\* Liste de pieces

\* Part list

\* Onderdelenlijst

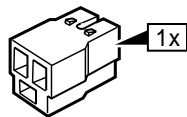
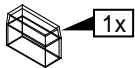
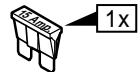
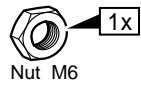
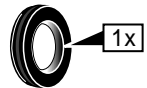
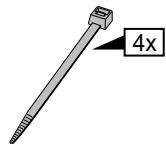
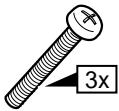
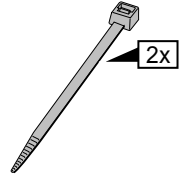
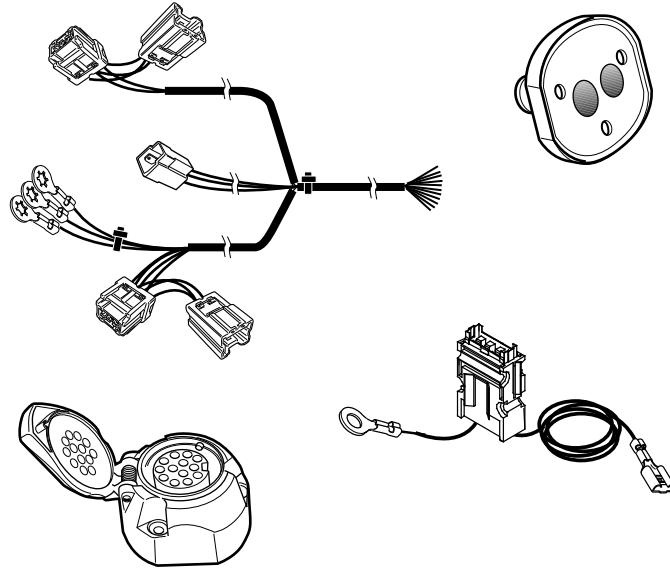
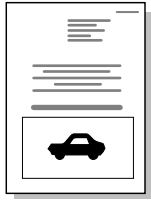
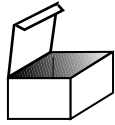

1

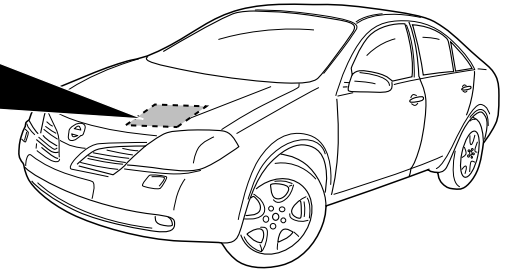
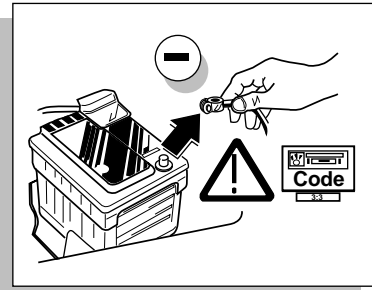

2

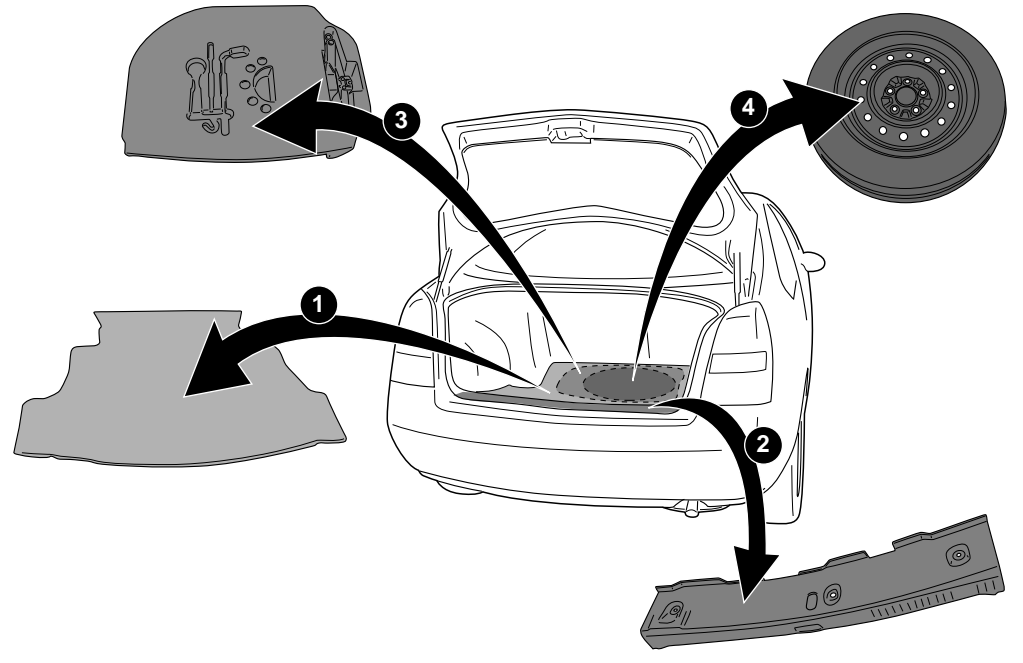

3

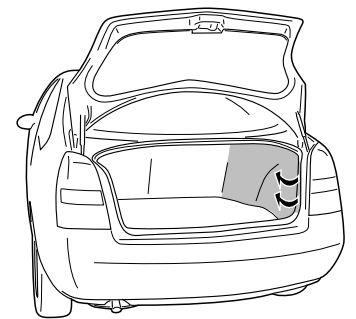
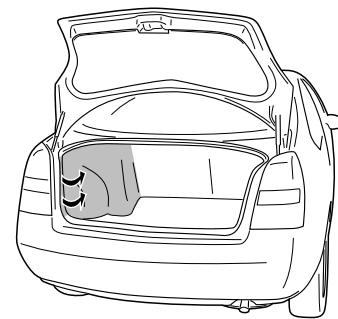

INFO

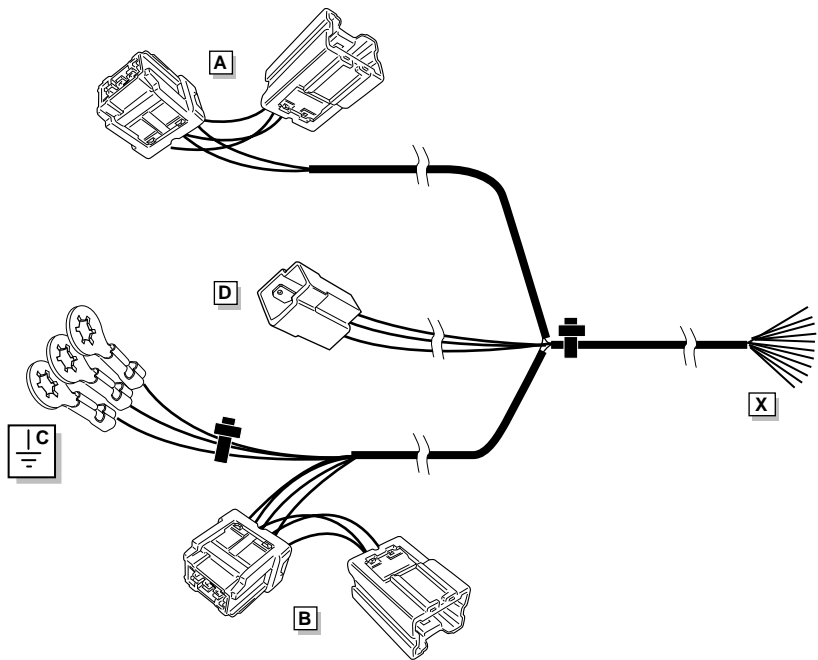

ROUTING

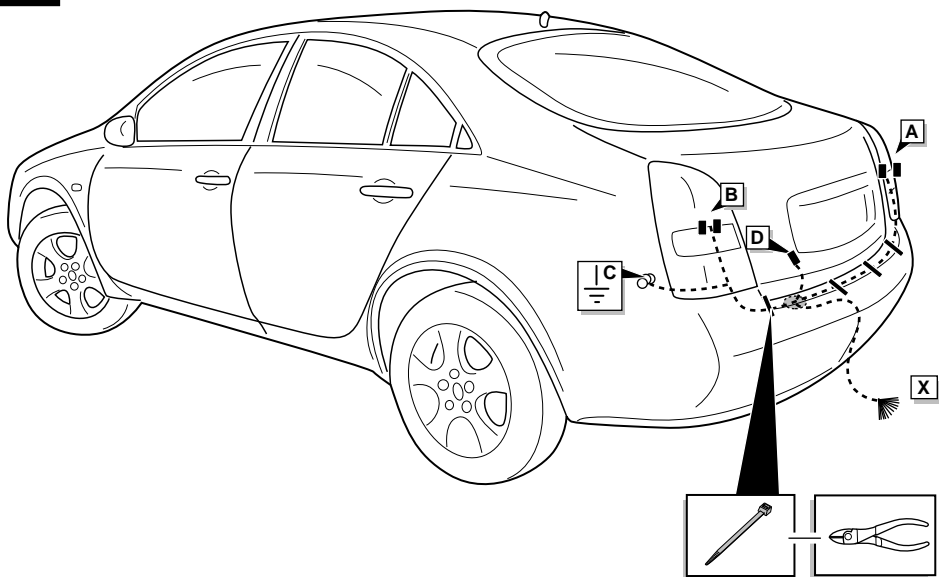

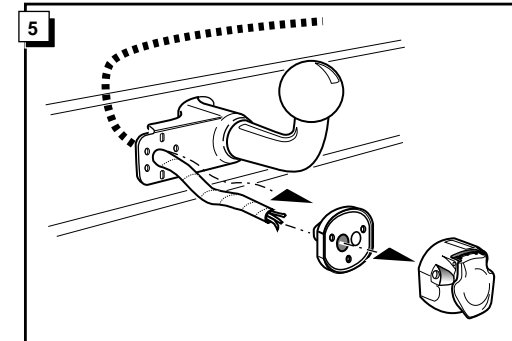
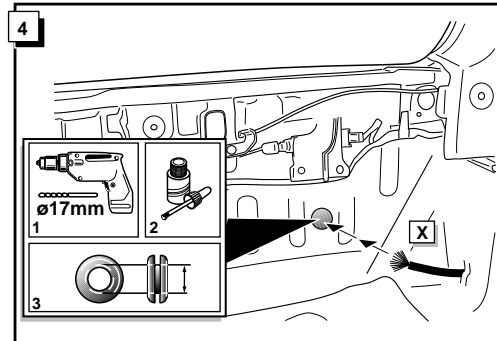
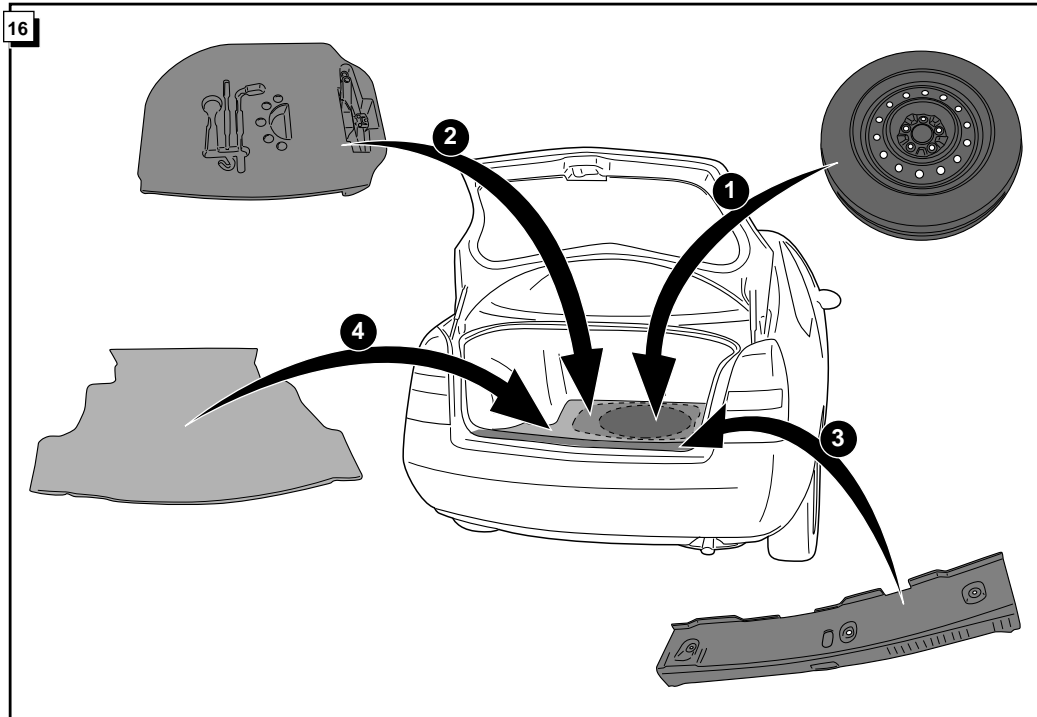

**INFO** Anschluß Steckdose / Connection de la prise / Socket connection / Contactdoos aansluiting

DIN/ISO 11446	D	F	GB	NL		
	1/L	gelb	jaune	yellow	geel	
	2	blau	bleu	blue	blauw	
	2a	grau	gris	grey	grijs	
	1-8	3/31	weiß	blanc	white	wit
	4/R	grün	vert	green	groen	
	5/58-R	braun	marron	brown	bruin	
	6/54	rot	rouge	red	rood	
	7/58-L	schwarz	noir	black	zwart	
	8	schwarz/rot	noir/rouge	black/red	zwart/rood	
	9	braun/weiß	marron/blanc	brown/white	bruin/wit	
	10	rot	rouge	red	rood	
	11	weiß	blanc	white	wit	
	12	rot/blau	rouge/bleu	red/blue	rood/blauw	
	13	weiß	blanc	white	wit	

